



**PALMPERFECT®**

**Beautytrim®**

OWNER'S MANUAL

model 3900WMB

version 22.11.18

Thank you for purchasing the PALMPERFECT® Beautytrim®. To ensure you have the best possible experience with this product, please read all instructions and precautions carefully before use.

## WARNING

This device is not a toy and is not intended for use by or on children. This device is intended for household use only. Do not use the device if it has a damaged blade or cutting unit, as injury may occur. Do not expose the device to direct sunlight, extreme temperatures or heated surfaces. This device is water resistant. It can be exposed to splashing water in the shower, and can be rinsed clean under the faucet. The device should not be completely submerged in water.

## PRODUCT FEATURES

1. Precision Blade
2. Detail Blade
3. On/Off Switch
4. Battery Door
5. Dual Length Trimming Guide
6. Protective Cap

## BATTERIES

The trimmer requires one (1) 'AAA' 1.5 volt battery for operation. Either alkaline or lithium batteries can be used. Do not use old or damaged batteries.

Battery installation / replacement:

1. Turn battery door counter-clockwise to unlock & remove (Fig. 1).
2. Insert (1) 'AAA' battery according to the polarity markings on battery door (Fig. 2).
3. Replace battery door and turn clockwise to lock.

Note: Replace the battery as soon as you notice the device is running slower than normal. Do not use old or damaged batteries.

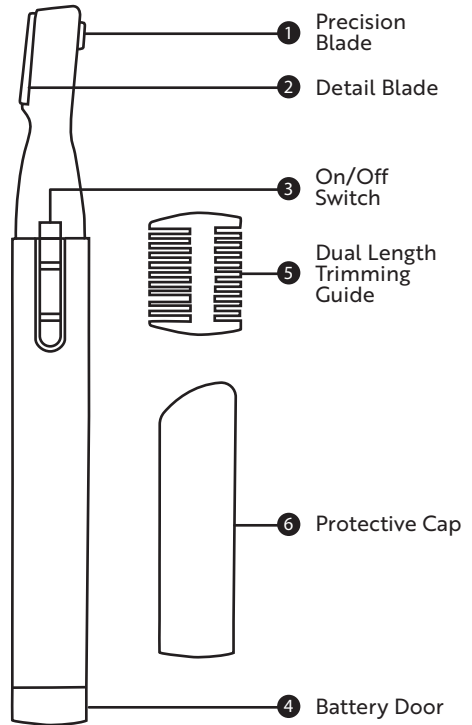

Fig. 1



Fig. 2



Fig. 3

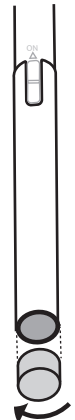

## USING THE BEAUTYTRIM®

Power the device ON and OFF using the slide switch on the front of the product. For best results, use short, even strokes. Apply only light pressure - it's not necessary to press hard. Experiment with the trimming guide and the different blades to achieve your desired look.

### ATTACHING THE TRIMMING GUIDE

The trimmer includes a comb attachment for trimming eyebrows or other hair at a guided level. The two sides of the comb will provide different lengths. To attach the guide, simply fit it over the blades and gently press down until it snaps into place (Fig. 4).

**WARNING:** In order to prevent injury, handle the guide by gripping the flat sides between thumb and index finger (Fig. 4). Do not attempt removal while gripping the bottom of the guide (Fig. 5).

### REPLACING THE TRIMMING BLADES

The blades of the trimmer may be removed for cleaning or replacing. To remove the blades, unlock the snap lock and lift off the blade assembly by gently pulling the blade away from the trimmer base. The blade assembly can be put back on by securing the top portion first and then pushing down and locking the bottom snap lock (Fig. 6).

### CLEANING

A small brush can be used to clean the blades and trimmer area, and a soft cloth can be used to gently wipe it clean. The blades can be removed from the trimmer and rinsed clean under water, but do not expose the main trimmer enclosure to water.

### CONTACT / WARRANTY / SUPPORT

The Beautytrim® carries a warranty against manufacturing defects (excluding cutting blades) for two years from the date of original purchase. Beacon Wellness Brands will, at our option and upon submission of a valid proof of purchase within the warranty period, repair or replace the shaver free of charge. For assistance or for issues related to performance, damages, blade replacement, warranty, regular maintenance or customer feedback, please contact us toll free at (800) 514-2546, Monday - Friday from 8:30AM until 5:30PM EST.

Beacon Wellness Brands  
85 Wells Ave  
Suite 106  
Newton, MA 02459 USA

© 2022 Beacon Wellness Brands, Inc.

Fig. 4

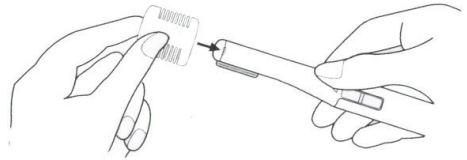

Fig. 5

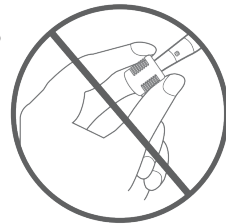

Fig. 6

